

Lock and Go

This software lets you password protect a drive. If you enable Lock and Go and set a password, the drive will be locked.

Notes:

- Keep your password secure. Anyone who finds your password can access your data. If you forget your password, you will not be able to access your data.
- This software does not encrypt data on the drive.
- Before you reformat the drive, unlock the drive or disable Lock and Go.

Installation

To install Lock and Go, follow the instructions below.

Note: The number in the filename represents the version of the software. The filename in the examples below may differ from the actual filename.

Windows

Download the software from <http://d.buffalo.jp/hd-pnfu3/>. Select "Lock and Go Setup (Windows)" and execute "lockandgosetup_100.exe".

Mac

- 1** Download the software from <http://d.buffalo.jp/hd-pnfu3/>. Select "Lock and Go Setup (Mac)" and download "lockandgosetup_100.dmg".
- 2** Double-click "lockandgosetup_100.dmg".
- 3** Double-click the "BUFFALO LockandGo" drive that was extracted to the desktop.
- 4** Copy "Lock and Go Setup" from the "BUFFALO LockandGo" drive to the Applications folder. To open the Application folder, click *Go - Applications*.

The installation process is now complete.

Enabling Lock and Go

To enable Lock and Go and lock the drive, follow the procedure below.

Note: The procedure below assumes that you have already installed the Lock and Go software on your device.

1 Connect the drive to your device.

2 Boot Lock and Go Setup.

Note: If "User Account Control" appears, click Yes.

Windows 8.1 :

Click  on the Start screen or slide up from the middle of the Start screen with your finger. From the Apps view, select "Lock and Go Setup".

Windows 8 :

Select "Lock and Go Setup" from the Start screen.

Windows 7 :

Select *Start - All Programs - BUFFALO - Lock and Go Setup - Lock and Go Setup*.

Mac :

Select *Go - Applications - Lock and Go Setup*.

3 Enter the desired password and hint and click *Lock Drive*.
Entering a hint is optional.

Windows

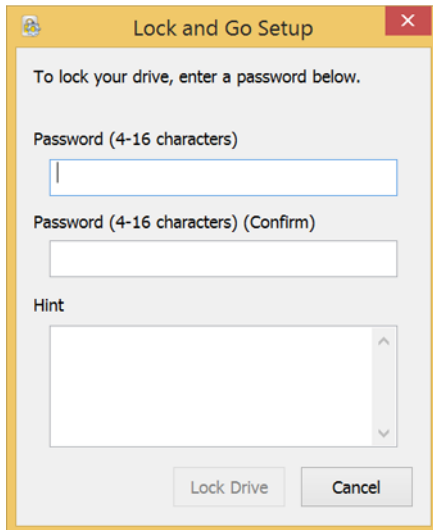
The Windows Lock and Go Setup dialog box has a yellow title bar with the text "Lock and Go Setup" and a close button. The main area is light gray and contains the text "To lock your drive, enter a password below." followed by three input fields: "Password (4-16 characters)" (a single-line text box), "Password (4-16 characters) (Confirm)" (a single-line text box), and "Hint" (a multi-line text area). At the bottom, there are two buttons: "Lock Drive" and "Cancel".

Mac

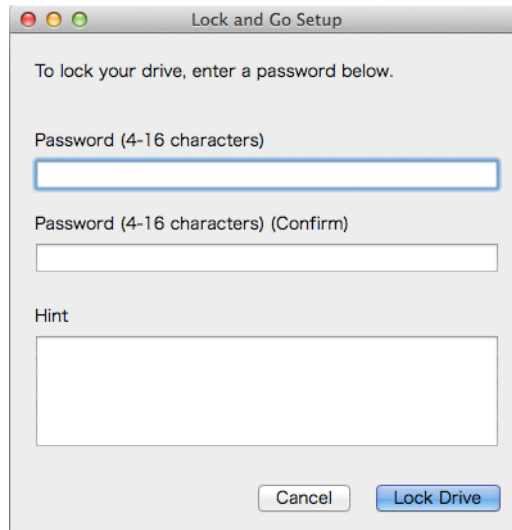
The Mac Lock and Go Setup dialog box has a gray title bar with the text "Lock and Go Setup" and standard Mac window control buttons. The main area is light gray and contains the text "To lock your drive, enter a password below." followed by three input fields: "Password (4-16 characters)" (a single-line text box), "Password (4-16 characters) (Confirm)" (a single-line text box), and "Hint" (a multi-line text area). At the bottom, there are two buttons: "Cancel" and "Lock Drive".

You have enabled Lock and Go.

Unlocking the drive

To unlock the drive, follow the procedure below. After unlocking the drive, you can access the data on it.

- 1 Connect the drive to your device.

For Windows, double-click  in Computer or PC.

For Mac, double-click  on the desktop.

- 2 For Windows, double-click "Lock and Go.exe" in the drive.
For Mac, double-click "LockandGo" in the drive.



- 3 Enter the password and click *Unlock*.

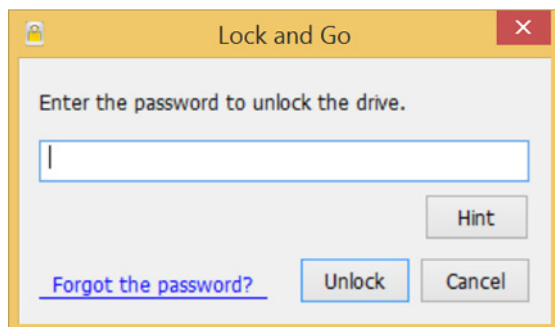

Windows



Mac



- 4 For Windows,  disappears from Computer or PC, and  or  appears instead.

For Mac,  disappears from the desktop, and  appears instead.

Wait until the icon appears.

When the unlocked icon appears, you can access the drive.

Disabling Lock and Go

To disable Lock and Go, follow the procedure below.

Note: Use the device with the Lock and Go software installed on it to perform the procedure below.

1 Connect the drive to your device.

2 Boot Lock and Go Setup.

Note: If "User Account Control" appears, click Yes.

Windows 8.1 :

Click  on the Start screen or slide up from the middle of the Start screen with your finger. From the Apps view, select "Lock and Go Setup".

Windows 8 :

Select "Lock and Go Setup" from the Start screen.

Windows 7 :

Select *Start - All Programs - BUFFALO - Lock and Go Setup - Lock and Go Setup*.

Mac :

Select *Go - Applications - Lock and Go Setup*.

3 Enter the password and click *Unlock*.

Windows

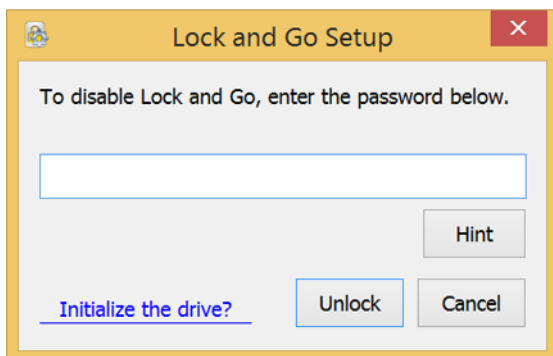

Mac



4 "Lock and Go is disabled" is displayed, click *OK*.

You have disabled Lock and Go.

Forgotten Password

If you forgot your password, you will not be able to access your data. Initialize the drive to reset the forgotten password. If you initialize, all data on the drive will be lost.

Notes:

- Use the device with the Lock and Go software installed on it to perform the procedure below.
- Initializing may take long time.
- Before initializing the drive, configure your computer so that it will not go into sleep mode. If your computer goes into sleep mode during the process, the drive will not be initialized correctly.
- For Mac, format this product with the Mac OS Extended format after initializing.

1 Connect the drive to your device.

2 Boot Lock and Go Setup.

Note: If "User Account Control" appears, click Yes.

Windows 8.1 :

Click  on the Start screen or slide up from the middle of the Start screen with your finger. From the Apps view, select "Lock and Go Setup".

Windows 8 :

Select "Lock and Go Setup" from the Start screen.

Windows 7 :

Select *Start - All Programs - BUFFALO - Lock and Go Setup - Lock and Go Setup*.

Mac :

Select *Go - Applications - Lock and Go Setup*.

3 Click *Initialize the drive?* then click OK.

Windows

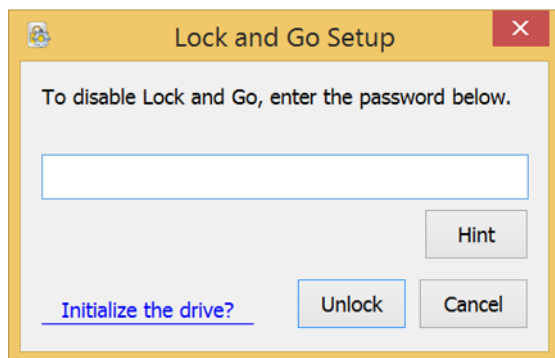

Mac

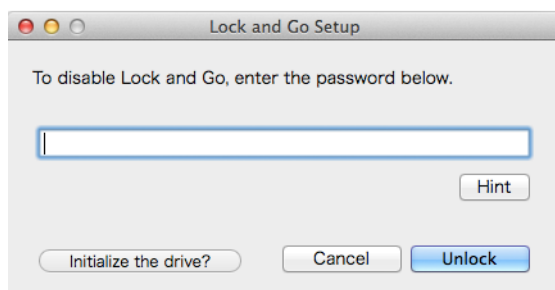

Step through the wizard to complete the initialization.

Uninstallation

Windows

The software can be uninstalled from within Control Panel.

Mac

To uninstall, delete "Lock and Go Setup" from the Application folder.